

APPENDIX C

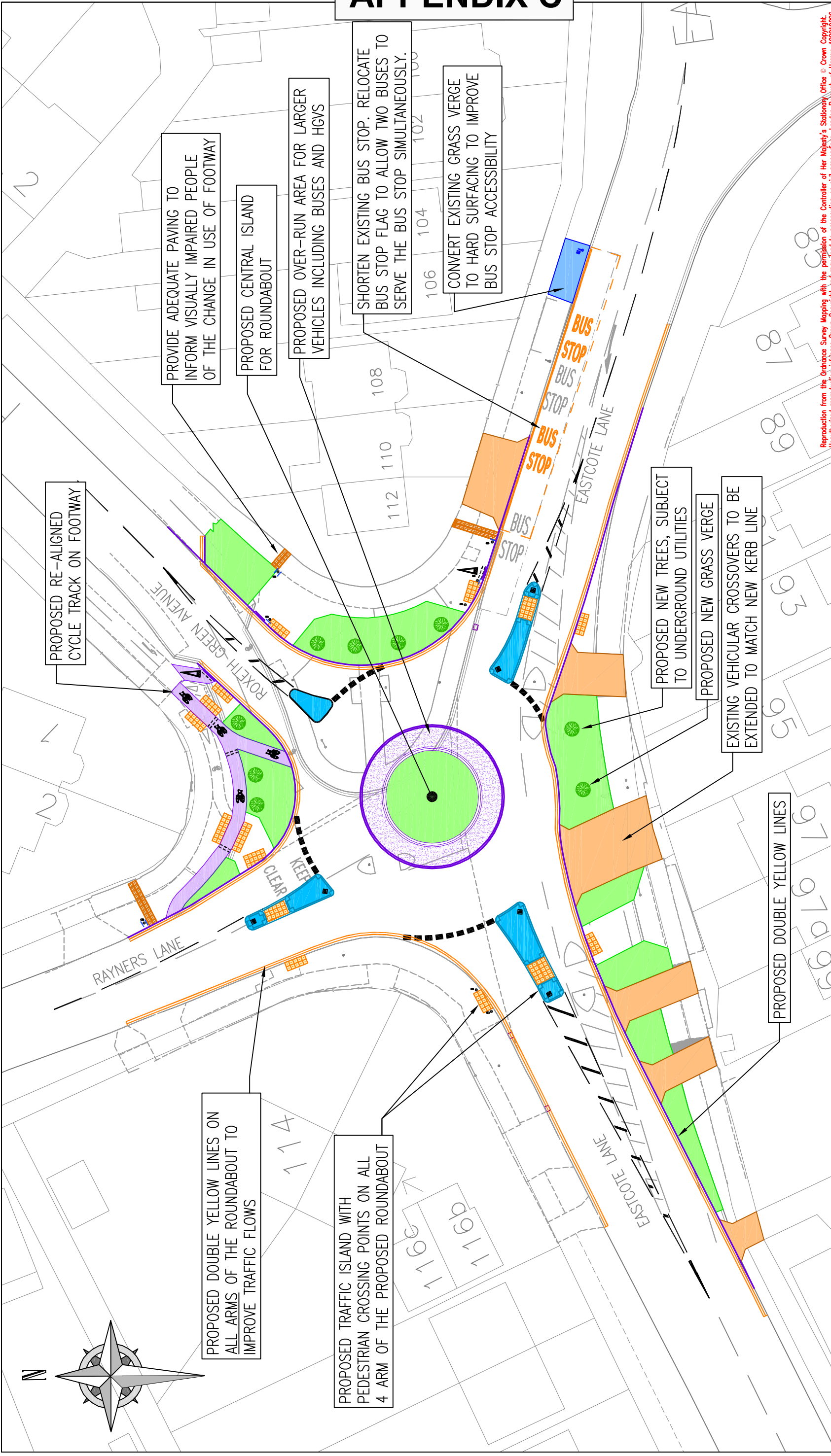

REVISION	INITIAL ISSUE	TP 19.09.12	TP 19.09.12	TP 19.09.12	BP 19.09.12	BP 19.09.12	
A	AMENDMENT						
		DRAWN BY AND DATE					DESIGNED BY AND DATE
		AND DATE					AND DATE
		AND DATE					AND DATE

		DEPARTMENT	TRAFFIC AND HIGHWAY NETWORK MANAGEMENT TEAM
		PROJECT	TPR0081 & 87 EASTCOTE LANE BUS PRIORITY
		DRAWING TITLE	OUTLINE DESIGN
			SHEET 1 OF 1
DRAFT	SCALE (AT A3 SIZE)	ISSUING OFFICE TRAFFIC TEAM	DRAWING NUMBER
ISSUE	NTS	TELEPHONE	T/DWG/000398
			REVISION
			A

KEY:	DESCRIPTION
	PROPOSED BOLLARD (WITH ADEQUATE SIGN IF REQUIRED) FOR PEDESTRIAN SAFETY
	PROPOSED NEW KERB LINE
	PROPOSED ROAD MARKINGS (WHITE COLOUR)
	PROPOSED DOUBLE YELLOW LINES (YELLOW COLOUR)
	PROPOSED CYCLE TRACK ON FOOTWAY
	PROBABLE TREE LOCATION
	PROPOSED TACTILE PAVING (BUFF COLOUR)
	PROPOSED PEDESTRIAN REFUGE ISLAND
	PROPOSED RE-ALIGNED VEHICULAR CROSS-OVERS TO BE EXTENDED TO NEW KERB LINE
	PROPOSED NEW GRASS VERGE
	PROPOSED VEHICLE OVER-RUN AREA FOR LARGER VEHICLES

Reproduction from the Ordnance Survey Mapping with the permission of the Controller of Her Majesty's Stationery Office © Crown Copyright. Unauthorized reproduction infringes Crown Copyright and may lead to prosecution or civil proceedings. London Borough of Harrow 100019206.